

Single Door Base Cabinets
B12, B15, B18, B21, B24S
(1 Drawer, 1 Shelf)

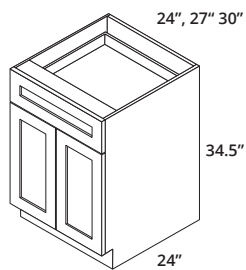

Double Door Base Cabinets
B24, B27, B30
(1 Drawer, 1 Shelf)

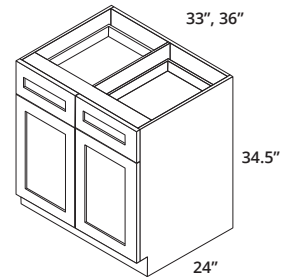

Double Door Double Drawer Cabinets
B33, B36
(2 Drawers, 1 Shelf)

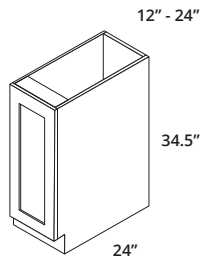

Single Door Full Height Base Cabinets
B12F, B15F, B18F, B21F
(1 Shelf)

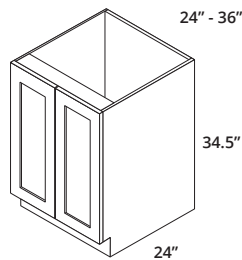

Double Door Full Height Base Cabinets
B24F, B27F, B30F, B33F, B36F
(1 Shelf)

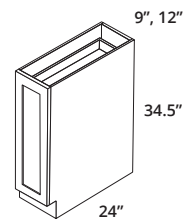

Base Spice Drawer Cabinets
BSH09, BSH12
(1 Pullout, 2 Shelves)

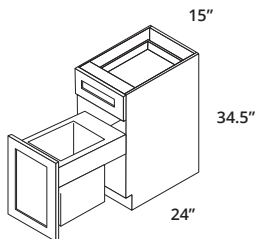

Single Trash Cabinet
BT15
(1 Drawer, 1 Trash Bin)

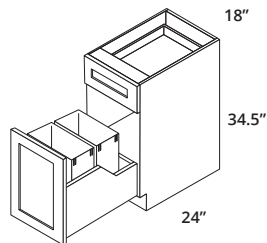

Double Trash Cabinet
BT18
(1 Drawer, 2 Trash Bins)

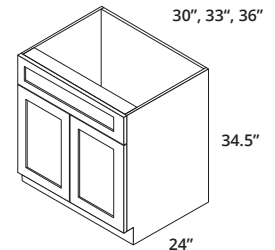

Sink Base Cabinets
SB30, SB33, SB36

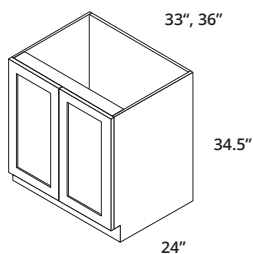

Full Height Sink Base Cabinets
SB30F, SB33F, SB36F

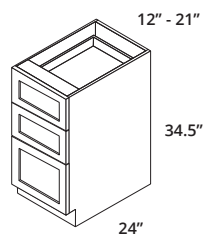

3-Drawer Base Cabinets
DB12, DB15, DB18, DB21

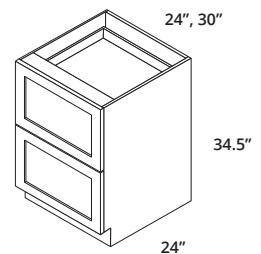

2-Drawer Base Cabinets
DB24, DB30

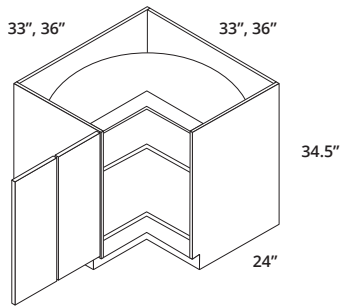

Lazy Susan Cabinets
BLS33, BLS36
(2 Bi-fold doors, 2 Turntable Shelves)

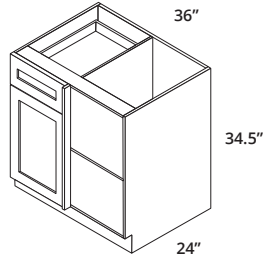

Blind Corner Base Cabinet
BBC42
(1 Drawer, 1 Shelf; 3" Filler Needed)

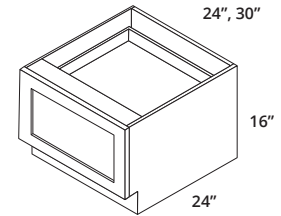

Oven Base Cabinet
OVB24, OVB30
(1 Drawer)

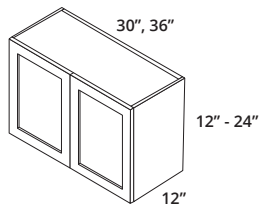

Wall Double-Door Over Appliance Cabinets
Depth: 12"
W3012, W3015, W3018, W3021, W3024,
W3612, W3615, W3616, W3621, W3624

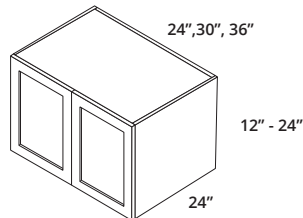

Wall Double-Door Over Appliance Cabinets
Depth: 24"
W242424, W301224, W301524, W301824,
W302424, W361224, W361524, W361824,
W362424

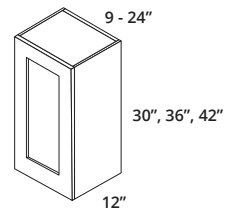

Wall Single-Door Cabinets
W0930, W1230, W1530, W1830, W2130, W2430S,
W0936, W1236, W1536, W1836, W2136, W2436S,
W0942, W1242, W1542, W1842, W2142, W2442S
(2 shelves included; 42" have 3 shelves)

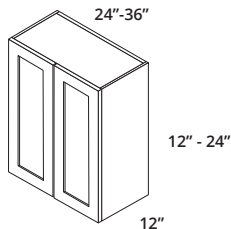

Wall Double-Door Cabinets
W2430, W2730, W3030, W3330, W3630,
W2436, W2736, W3036, W3336, W3636,
W2442, W2742, W3042, W3342, W3642
(2 shelves included; 42" have 3 shelves)

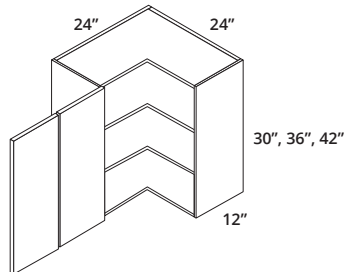

Wall Corner Cabinets
WER2430, WER2436, WER2442
(2 shelves included; 42" have 3 shelves)

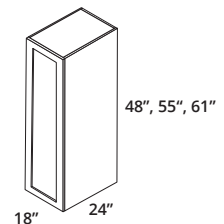

Wall Pantry Single-Door Top Cabinet
PW184824, PW185524, PW186124,
PW244824S, PW245524S, PW246124S
(2 shelves included; 61" have 3 shelves)

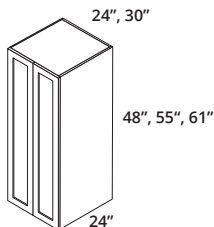

Wall Pantry Double-Door Top Cabinet
PW244824, PW245524, PW246124,
PW304824, PW305524, PW306124
(2 shelves included; 61" have 3 shelves)

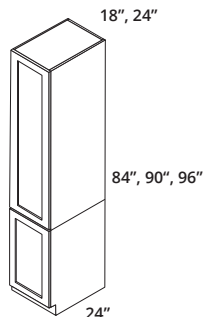

Wall Pantry Single-Door Cabinet
PW188424, PW189024, PW189624,
PW248424S, PW249024S, PW249624S

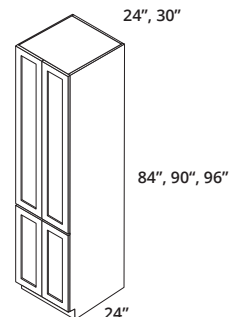

Wall Pantry Double-Door Cabinet
PW248424, PW249024, PW249624,
PW308424, PW309024, PW309624

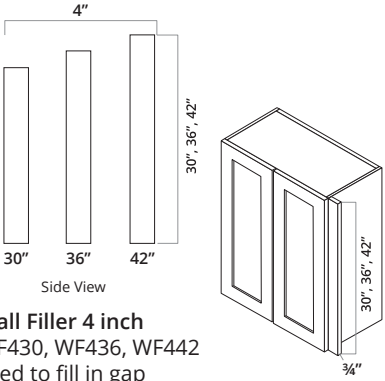
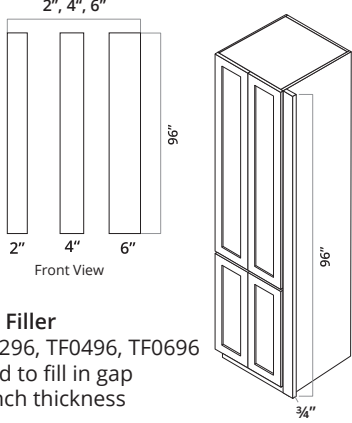
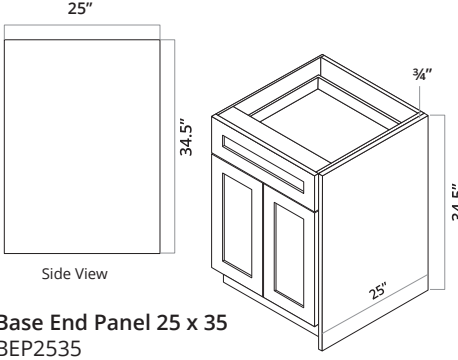
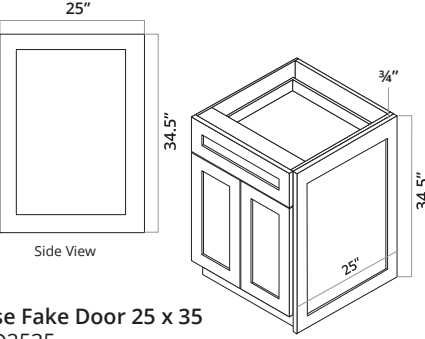
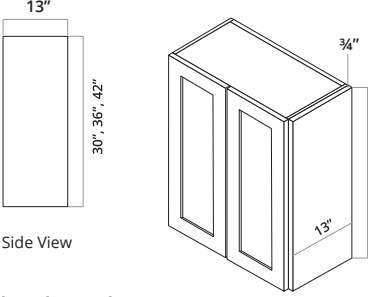
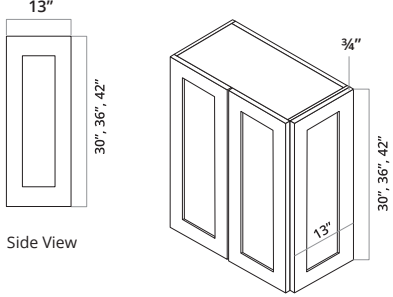
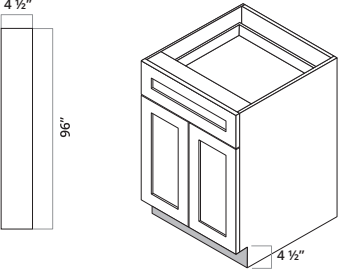
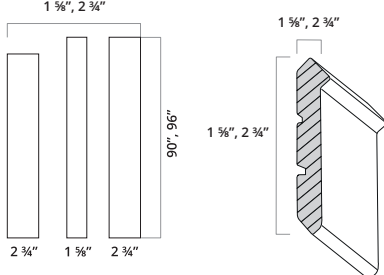
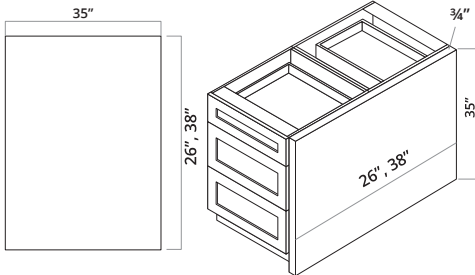
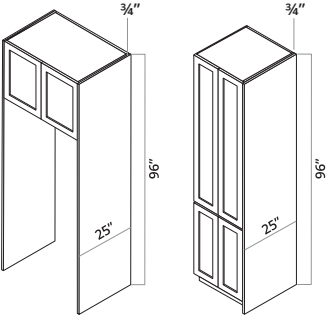
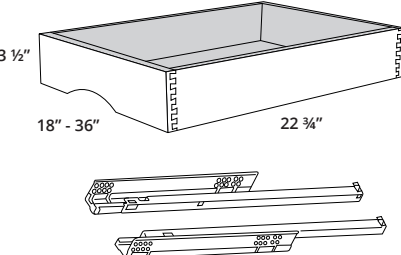
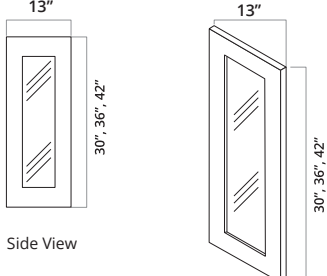
 <p>Wall Filler 4 inch WF430, WF436, WF442 used to fill in gap 3/4 inch thickness</p>	 <p>Tall Filler TF0296, TF0496, TF0696 used to fill in gap 3/4 inch thickness</p>	 <p>Base End Panel 25 x 35 BEP2535 used to finish end of base cabinet 3/4 inch thickness</p>
 <p>Base Fake Door 25 x 35 BFD2535 used to finish end of base cabinet 3/4 inch thickness</p>	 <p>Wall End Panel WEP1330, WEP1336, WEP1342 used to finish end of base cabinet 3/4 inch thickness</p>	 <p>Wall Fake Door WFD1330, WFD1336, WFD1342 used to finish end of base cabinet 3/4 inch thickness</p>
 <p>Toe Kick BFD2535 used to finish bottom of base cabinet 3/4 inch thickness</p>	 <p>Flat Crown Molding CMF2-96, CMF4-90, CMF4-96 used to install top of wall cabinet</p>	 <p>Island End Panel IEP2635, IEP3835 used to finish end of base cabinet 3/4 inch thickness</p>
 <p>Tall End Panel 35 x 96 PNL3596 used to finish tall cabinet or refrigerator 3/4 inch thickness</p>	 <p>Roll Out Drawer ROD-B18, ROD-B21, ROD-B24, ROD-B27, ROD-B30, ROD-B33, ROD-B36 used for pull out drawer in cabinet</p>	 <p>GLASS DOORS GD1230, GD1530, GD1830, GD1236, GD1536, GD1836, GD1242, GD1542, GD1842</p>